



IndigoVision



Bullet Cameras

High-end: performance, not price tag.

With BX HD Bullet Cameras you get supreme connectivity and flexibility, combined with great video and audio. You also get maximum reliability, and the other significant benefits of IndigoVision's Distributed Network Architecture. BX HD Bullet Cameras deliver a different dimension of safety when combined with IndigoVision's Control Center.

Key Features

SENSOR



COMPRESSION



INTELLIGENCE



OTHER



PHYSICAL

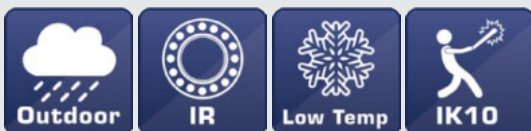

Product Codes

BX630 Bullet Camera	
HD Bullet Camera, Standard Lens, 2.7-12mm	610661
HD Bullet Camera, Telephoto Lens 7-35mm	610662

Dimensions - Bullet Camera

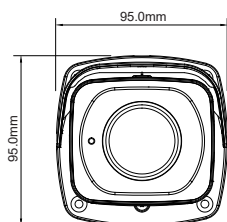

View on Front Face

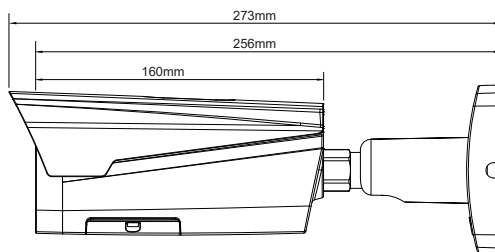

View on Side Face

Dimensions - Mounting Hole Pattern

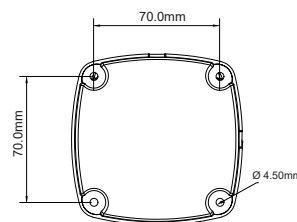

View on Front Face

Specification

Camera Features	Standard Lens	Telephoto Lens
Sensor	1/2.8" Progressive CMOS	
Active Pixels (HxV)	HD (1920x1080)	
Minimum Sensitivity	Day: 0.05 Lux (colour). Night: 0.0 Lux (mono). 30 IRE, F1.4, 1/30s shutter	
Dynamic Range	WDR > 120dB	
Gain Control	Auto/Manual setting	
Back Light Compensation	On/Off	
White Balance Mode	Auto/Manual	
Day/Night	True Day/Night with Mechanical IR Cut Filter	
IR Illuminator	Std: Built-in IR Illuminator 850nm wavelength, effective distance >50m	Built-in IR Illuminator 850nm wavelength, effective distance >100m
Video Resolution	1920x1080 pixels (HD); 1280x960 pixels (1.3MP); 1280x720 pixels (720p); 704x576 pixels (D1); 704x480 pixels (D1) 352x288 pixels (SIF); 352x240 pixels (SIF)	
Signal/Noise Level	> 50dB	
Lens Options	2.7mm - 12mm, F1.4, Vari-focal with Remote Zoom/Focus	7mm - 35mm, F1.4, Vari-focal with Remote Zoom/Focus
Shutter	Rolling; Auto from 1/30 - 1/100,000	
Exposure Control	Auto/Manual	
Video Compression	Full frame rate, full colour: H.264/MJPEG ; up to 60fps	
Privacy Zones	4 User Defined	
Video Bit Rate	User-configurable bit rates from 24Kbps up to 10Mbps	
Video Multi-Streaming	Up to 32Mbps total video output; Unlimited multicast connections; Up to eight 4Mbps unicast connections; Up to sixteen 1Mbps unicast connections	
Video Multi-Encoder	Two simultaneous resolutions including: up to 1080p (60fps) plus 720p (20fps) or lower Or two simultaneous resolutions including: up to 1080p (30fps) plus 1080p (30fps) or lower	
Video Analytics	Motion Detection, Hooded, Tripwire, Intrusion, Abandoned Object, Missing Object	
Audio Compression	G.711Mu	
Audio Bit Rate	Non user configurable, G.711Mu 64Kbps - 80Kbps	
Audio Resolution	G.711Mu 8kHz sample rate, Mono Input, Mono Output	
Audio Analytics	Audio Detection	
Audio Input	Line in, RCA connector	
Audio Output	Line out, RCA connector	
Binary Input/Output	2 Pull up inputs for non powered contacts; 1 solid state open collector output with 5VAC/DC 30mA max carrying capacity	
Network Interface	IEEE802.3 and IETF standards: 10/100 Base-T Ethernet, IPv4/IPv6, TCP, UDP, RTP, RTSP, ICMP, IGMP, SNMP, HTTP, HTTPS, PPPoE, uPnP, QoS, DHCP	
Network Security	HTTPS, IP Filter, IEEE 802.1x	
Time	Embedded real-time clock, NTP client	
SD Storage	microSDHC 128GB support (card not included)*	
Dimension/Weight	94.92mm (h) x 94.92mm (w) x 272.90mm (l) and 1.1Kg (with sun shade) / 3.74in (h) x 3.74in (w) x 10.74in (l) and 2.43lb (with sun shade)	
Regulatory	EN55032, EN55024, EN50130-4, EN61000-3-2, EN61000-3-3, FCC Part 15 Subpart B Class A, IEC60068-2-27, IEC60068-2-6, EN60068-2-64, EN60068-2-1, EN60068-2-2, EN60068-2-30, UL60950-1	
Housing	White vandal resistant aluminium alloy with polycarbonate sun shade including 200mm cable bundle	
Protection Rating	IP67, IK10	
Operating Temperature	-40°C to 60°C	-30°C to 60°C
Cold Start	-20°C	
IndigoVision Software Requirements	Control Center v15.1 or later	
Supported Internet Browsers	Internet Explorer v11.0 or later	
ONVIF	Profile S	
Electrical	Camera only: PoE+ (802.3at Class 4) or 12V DC @ 0.92A: 11W Camera including heater: PoE+ (802.3at Class 4) or 12VDC @ 1.66A; 20W. Power supply ordered separately (Product code: 110068; 130176)	

* SDCard Storage independent of IndigoVision's NVRs.